



MLR-352H-PE

MLR

Climate Chambers

294 L

Versatile Climate Chambers

MLR CLimate Chambers with LED lighting are suitable for a wide range of applications, including plant growth and insect studies. The wide variety of temperatures, humidity and lighting patterns that are essential in research, environmental studies and testing can be accurately reproduced and controlled.

Efficient Performance

High performance refrigeration and humidity systems deliver a stable environment with excellent recovery after door openings. LED lamps and low GWP refrigerant help minimize environmental impact and achieve sustainability goals. An ultrasonic vapor generator and membrane humidity sensor provides accurate humidity on demand (MLR-352H-PE).

Programmed Temperature, Lighting

Up to ten programs can be stored in the microprocessor memory, each with up to 12 steps over time. Programs can be cyclical, step and repeat, step to constant setpoint or any combination of temperature, lighting and time over the condition range. Ramp up, down, and dwell points can be established and repeated to individual protocols. Lights can be programmed over a range of combinations.

Cabinet Design

Slim profile cabinet makes efficient use of available floor space. Robust cabinet construction with corrosion resistant stainless steel surfaces simplify cleaning and eliminate rust due to high humidity. Four wire and one solid shelf are fully adjustable for a multitude of configurations. Access port comes as standard.



Efficient Airflow

The forced-air circulation creates precise temperature and humidity uniformity throughout all levels of the cabinet. Airflow is halted automatically upon door openings to mitigate environmental changes. The efficient airflow enhances recovery of all parameters following door openings. Magnetic gasket helps maintain a completely sealed inner chamber.

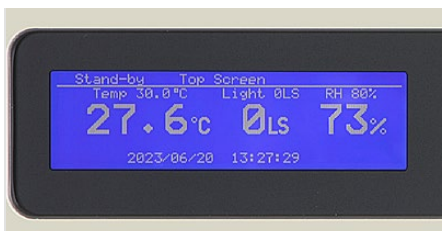

Microprocessor Control

Performance is managed by a microprocessor controller with memory back-up. Inputs and displays are through an alphanumeric LCD viewscreen via touchpad entry for setpoints and programming. Pop-up menus display current parameters and status of temperature, direct humidity, lights, door ajar and alarm deviations.



Wide Range of Applications

The PHCbi climatic test chambers support a wide range of applications. Creating the optimum environments for research and testing protocols.

MLR Climate Chambers



Lamps

High efficiency LED lamps are arranged in programmable banks of five lamps in the door, left and right side interior. Lamps are programmable in up to 6 combinations from zero to 15 lamps on.

Programmable Settings

The temperature and light settings are programmable to provide the perfect cycles for your applications. The unit allows the programming of starting day and time of operation and 10 programmes of up to 12 steps each to be memorized. Switch between the selectable clock mode or timer mode and use of the Join Mode for allowing multiple programs to be linked.

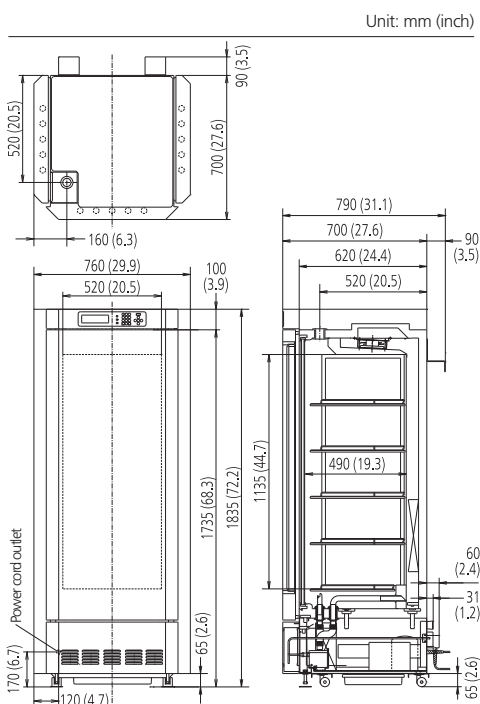

Model Number		MLR-352H-PE
External Dimensions (W × D × H)	mm	760 × 700 × 1835
Internal Dimensions (W × D × H)	mm	520 × 490 × 1135
Volume	liters	294
Net Weight	kg	223
Performance		
Temperature Control Range & Fluctuation	°C	+5 ~ +50 (lamp off) +/-0,3 +10 ~ +50 (lamp on) +/-0,3
Temperature Uniformity ¹⁾	°C	±1 (lamp off) ±2.5 (lamp on)
Humidity Level & Fluctuation	%RH	60~90 / LS:0 (15~45°C) 5 5~85 / Lamps On (15~45°C)
Light control range	Lux	Programmable 0 ~ 20000
Light setting range		6 steps
Control		
Temperature Sensor		Thermistor
Display		LCD
Refrigeration		
Refrigerant		R-1234yf
Refrigerant weight	g	270
Refrigerant GWP		0.501
Total Refrigerant weight (CO ₂ equivalent)	t	0.00014
Construction		
Exterior Material		Painted Steel
Interior Material		SS SUS-304
Insulation Material		PUF
Outer Door	qty	3
Outer Door Lock		N/A
Inner Door	qty	1
Shelves	qty	4pcs, hard steel wire on polyester coating, W465 x D450 mm (inner dimensions) 1pc (bottom), hard steel wire on polyester coating with stainless cover W355 x D395 mm (inner dimensions)
Max. Load per Shelf	kg	25
Access Port	qty	1
Access Port Position		Top left
Access Port Diameter	Ø mm	40
Alarms [R = Remote Alarm, V = Visual Alarm, B = Buzzer Alarm]		
Power Failure		R
Out of Temperature Setting		V-B-R
High limit temperature		B-R
Out of Humidity Setting		V
Door open		V-B
Electrical and Noise Level		
Power Supply	V	230
Frequency	Hz	50
Noise Level	dB	48 dB

Appearance and specifications are subject to change without notice.

¹⁾ Set temperature 25 °C, ambient 20 °C, no load

PHC Europe

A Member of PHC Group

Eikdonk 1 | 4825 AZ Breda | Netherlands
T: +31 (0) 76 543 3833

www.phcd.com/eu/biomedical